



Queen Elisabeth Music Chapel

A unique experience



Sous la Présidence d'Honneur de Sa Majesté la Reine Paola
Onder het Erevoorzitterschap van Hare Majesteit Koningin Paola
 Under the Honorary Chairmanship of Her Majesty Queen Paola



La musique et la formation des
 jeunes me tiennent particulièrement
 à cœur et je me réjouis de les voir
 réunies au sein de la Chapelle Musicale
 Reine Elisabeth.
 Mon souhait le plus cher est que le
 niveau d'excellence de la Chapelle
 puisse aider des jeunes talents à donner
 le meilleur d'eux-mêmes et à construire
 une élite musicale internationale
 au-delà des cultures et des frontières.

Musiek en de vorming van jongeren
 liggen me erg nauw aan het hart
 en het verheugt me deze verenigd
 te zien binnen de MuziekKapel Koningin
 Elisabeth.
 Mijn innigste wens is dat het excellentieniveau
 van de MuziekKapel jonge talenten noge
 helpen om het beste van zichzelf te geven,
 en zo een internationale muzikale elite
 te vormen, over culturen en grenzen heen.

Paola

Music and the training of young people mean a lot to me, and I am delighted to see them here at the Queen Elisabeth Music Chapel.
 My dearest wish is that the level of excellence of the Music Chapel will help young talents to give their best and to create an international musical elite, beyond borders and cultures.

Principal Sponsor



Co-sponsors



Co-sponsors



The Music Chapel

69 Artists in residence

26 Nationalities

9 Masters in residence

José van Dam, voice

Sophie Koch, voice

Chair granted by an anonymous donor

Augustin Dumay, violin

Corina Belcea, chamber music

Miguel da Silva, viola & chamber music

Gary Hoffman, cello

Frank Braley, piano

Avedis Kouyoumijian, piano

Jean-Claude Vanden Eynden, chamber music

“Community Projects” Chair

Chair granted by Fondation Futur21





Augustin Dumay,
Master in Residence, violin



Gary Hoffman,
Master in Residence, cello



José van Dam,
Master in Residence, voice



Tedi Papavrami,
Guest master, violin



Renaud Capuçon,
Guest master, MuCH Ensemble



Bertrand Chamayou,
Guest master, piano



Miguel da Silva,
Master in Residence, viola, chamber music



Corina Belcea,
Master in Residence, chamber music



Frank Braley,
Master in Residence, piano



Stéphane Degout,
Guest master, voice



Quatuor Ebène,
Guest master, chamber music



Avedis Kouyoumdjian,
Master in Residence, piano



Sophie Koch,
Master in Residence, voice



Jean-Claude Vanden Eynden,
Master in Residence, chamber music



Hartmut Rohde,
Guest master, viola



Enter the laboratory

An artistic project at the origin of the Music Chapel

A Queen's project

Inaugurated on 12 July 1939, the **Queen Elisabeth Music Chapel** provides high-level training to exceptional young talents.

A training center of excellence with an international scope and reputation, its curriculum is reserved for outstanding musicians (the musical elite of tomorrow) in the disciplines of piano, violin, cello, viola, chamber music and voice. At the time of its creation already, the renowned critic Emile Vuillermoz described the Music Chapel as a sort of “modern Villa Medici”.

Openness, flexibility and excellence: an overhaul of the contents in 2004

Sixty-five years after the inauguration, in 2004, the Music Chapel set about reorganizing thoroughly its training and professional insertion program. The artistic training of the Music Chapel rests on **three pillars**:

- **Openness**: although anchored in the Belgian landscape, the Music Chapel has an international vocation;
- **Flexibility**: the Music Chapel seeks to adapt itself to each young artist's profile by providing him or her with a tailor-made program (variable cycles);
- **Excellence**: the Masters in Residence, as well as the Guest Masters – currently **José van Dam, Miguel da Silva, Augustin Dumay, Louis Lortie, Gary Hoffman, Vineta Sareika & Gregor Sigl, Sophie Koch et Jean-Claude Vanden Eynden** - and their guests (**Stéphane Degout, Corine Belcea, Stéphane Denève, Frank Braley, Christopher Warren-Green, Christian Arming, Tabea Zimmermann, Bernard Foccroulle, Benoît Mernier, Roberto Díaz, Giuliano Carmignola, Piotr Anderszewski, Gautier et Renaud Capuçon, Pavel Vernikov, Frans Helmerson, Philip Setzer, Guy Van Waas, Andreas Zimmermann...**) bear witness to the importance of knowledge transmission from one generation to the next.

The opening of the Haas-Teichen concert hall in 2015 made it possible for the Music Chapel to be officially recognized by the public authorities as a cultural venue and to receive support from the Wallonia-Brussels Federation from 2018 onwards.

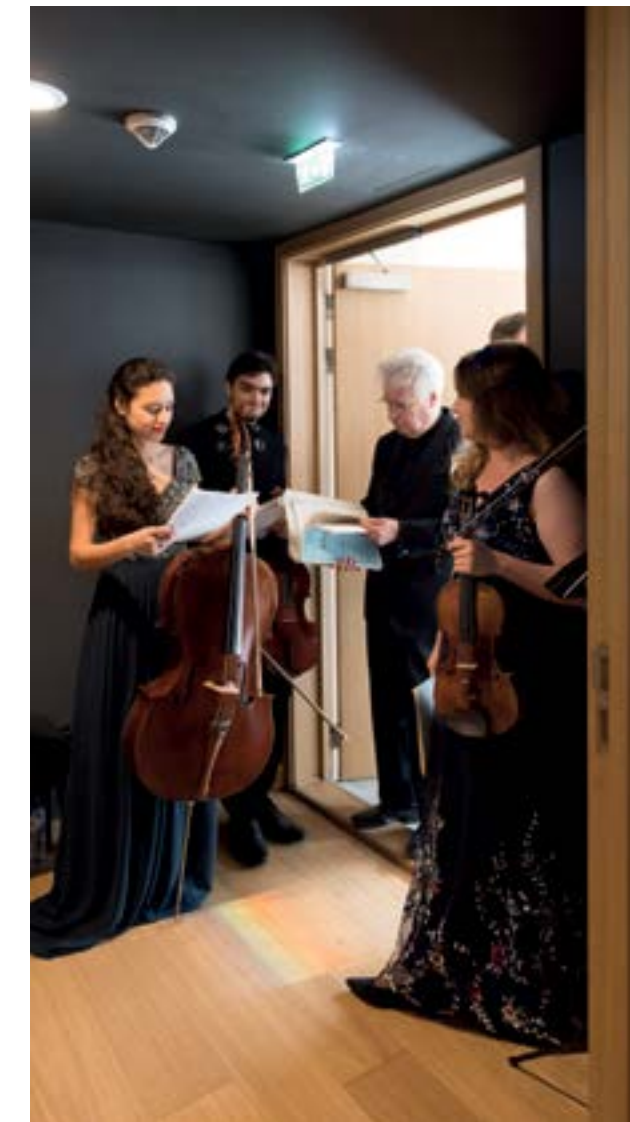



The art of transmission

A training, performance and creative center, the Music Chapel wishes, wishes to give, a voice to all the actors in residence: the young talents, masters, teachers and the team of the Music Chapel!

The Music Chapel is alive through its network of artists – between 70 and 80 artists in residence, many associated artists, about 20 nationalities, 9 masters in residence, guest masters as well as many guest artists throughout the year – as well as through its performance projects: 300 concerts, «MuCH» in Belgium and «on Tour» seasons, two festivals and many coproductions abroad.

B de Launoit

Bernard de Launoit
Executive President



A center of artistic excellence



Each musician’s training is individually tailored along **six main lines**:

1. High level training:

The presence of the masters, each of whom is pursuing an intense professional career in the world of music, constitutes the cornerstone of our pedagogical project. **The transmission of knowledge** with the master occurs for instance through the informal transmission of professional experience as well as the master’s accompaniment and support during the young musical talent’s first steps of his or her professional insertion, and the shared experience of performing side by side. In order to carry out this training, the Music Chapel provides artists with exceptional instruments, including 2 concert pianos, 30 pianos distributed in the classrooms and studios, and about ten ancient instruments on loan thanks to the support of various patrons. In 2016, the Baillet-Latour Fund made it possible to create a modern instrument fund by ordering cellos, violins and violas from eight European luthiers. All these instruments are on loan to the artists in residence or associated artists for a period of 3 to 5 years. At the end of their training, some artists in residence have the opportunity to perform an «Artist Diploma» concert in public. The **Artist Diploma** performances are more than simple concerts. While they represent the end of a cycle, they also open up new horizons and above all are the culmination of a musical and artistic training. After years of growing under the eyes of the public, these musicians thank the audience by presenting a project or program that is dear to them.

2. Professional insertion:

A particularly extensive program of concerts and recitals ensures the professional insertion of the young soloists. The Music Chapel is in this sense not only an “actor” in the music world, but also a “pilot institution” through its links with the music world on the international stage. The Music Chapel is integrated in a solid network of national and international partners:

National orchestras and choirs: Belgian National Orchestra, Brussels Philharmonic, Orchestre Philharmonique Royal de Liège, Orchestre Royal de Chambre de Wallonie, Brussels Chamber Orchestra, Orchestre Symphonique de la Monnaie, Vlaams Radio Koor, Le Concert d’Anvers, Antwerp Symphony Orchestra, Octopus, Les Métamorphoses,...

International orchestras: Koninklijk Concertgebouworkest (NL), London Chamber Orchestra (UK), Sinfonia Varsovia (Poland), Kansai Philharmonic Orchestra (Japan), Musica Viva (Russia), Wiener KammerOrchester (Austria), Orchestre National de Lille (France), Orchestre de Bienne Soleure (Switzerland), Ensemble Appassionato (France),...



Venues: Concertgebouw, Flagey, BOZAR, La Monnaie, Royal Palace of Brussels, several venues part of *the Belle Saison* project, Palazzo Sangiovanni (Alessano), Palais des Congrès (Bienne), Konzertsaal (Soleure), Fondation Louis Vuitton (Paris), Miry Concertzaal (Koninklijk Conservatorium Gent), Concertgebouw Brugge, NCPA (Mumbai), Mazda Hall (Pune), Phillips Collection (Washington), Frick Collection (New York), Yamaha Hall (New York), Salle Bourgie (Montréal), Opéra de Monte-Carlo (Monaco),...

National festivals: Musicales de Beloeil, Midi Minimes, Eté Mosan, Classissimo, Festival de Wallonie, Zomer van St Pieter, Vauxhall Summer Festival, Festival Piano Days,...

International festivals: The Poona Music Society (India), Abu Dhabi Music & Arts Fondation (United Arab Emirates), Schiermonnikoogfestival (Netherlands), Radio France Montpellier festival, Festival de Menton, Auditorium du Louvre, Festival d’Aix-en-Provence (France), Crans-Montana Classics, Tibor Varga Festival (Switzerland), Festival de Ravello, Festival LacMus, Pietrasanta in Concerto (Italy), Varma Festival (Bulgaria), Festival International de Musique Symphonique d’El Jem (Tunisia), Istanbul Foundation for Culture & Arts, Ephesus Foundation (Turkey),...

Home productions: MuCH Music Season (since 2015), Music Chapel Gala Concert (since 2010), Music Chapel Festival à Flagey (since 2010), MuCH Waterloo Festival (since 2017), Prelude à la St. John’s International School (since 2017), Eté musical (since 2020).

International tours: Queen Elisabeth Musical Voyage (2007 - 2009 - 2011 - 2013 - 2016) Varsovia and Gulbenkian Orchestra, tours in India, Japan, US (New York, Washington), Monaco (Monte-Carlo), residencies in Villecroze, at the Domaine Forget (Charlevoix), Québecà, Salle Bourgie (Montreal),...

As a **cultural ambassador for Belgium**, the Chapel takes part:

- Abroad: in state visits, economic missions and events organized by the Foreign Affairs.
- In Belgium: prestigious events at the Royal Palace, in the context of NATO or EU meetings.

For several years, the Music Chapel has developed its policy of video recordings and live streams. This digital presence reflects the Chapel’s aim to disseminate its productions more efficiently and more broadly nationally and internationally, but also to give the artists in residence greater visibility on the digital stage, ensuring them a more wide-ranging promotion and an archival tool for the early phases of their careers. **MuCH on air** is a series of “online” concerts shown on the YouTube channel of the Music Chapel.



3. The promotion of the young artists in residence:

This promotion notably takes the form of the Music Chapel's CD collection on the label Outhere, but also of its contacts with the international press. The recording and broadcasting by radio station Musiq3 concerts of the young musicians' Artist Diplomas also contribute to this promotion.

Discography of the Music Chapel: a collection on the Outhere label (Fuga Libera & Zig Zag/Alpha), including 20 CDs to date:

2006 :

- Plamena Mangova, Works for piano by D. Shostakovich
- Milos Popovic, Works for piano by R. Schumann

2008 :

- Trio Dali, Trio – Violin and cello sonata – Violin and piano sonata by M. Ravel

2010 :

- Orchestre Philharmonique Royal de Liège and soloists of the Music Chapel, conducted by Patrick Davin, Violin concertos by H. Vieuxtemps

2011 :

- Sinfonia Varsovia, conducted by Augustin Dumay, with Hrachya Avanesyan, Violin concerto and other works by A. Dvorak

2012 :

- Nikita Boriso-Glebsky, Spanish symphony – Sonata – Arlequin – Guitar by E. Lalo

2013 :

- Orchestre Philharmonique Royal de Liège, conducted by Christian Arming and soloists of the Music Chapel, Complete works for violin and orchestra and for cello and orchestra by C. Saint-Saëns

2015 :

- Orchestre Philharmonique Royal de Liège and soloists of the Music Chapel, Complete concertante works by E. Lalo

2016 :

- Busch Trio, Piano and string trios by A. Dvorak

2017 :

- Sarah Laulan, «Les Blasphèmes», Méloides de fin de siècle, various composers
- Soloists of the Music Chapel, Chamber music works by A. Reicha
- Busch Trio and Miguel da Silva, Quartets by A. Dvorak

2018 :

- Busch Trio, Miguel da Silva and Maria Milstein, Quintets by A. Dvorak
- Hélène Desaint, Works by R. Schumann and G. Kurtag

2019 :

- Trio Zadig, Works by B. Attahir, M. Ravel and L. Bernstein
- Rolston String Quartet, «Souvenirs» by P. Tchaikovsky
- Bush Trio, Complete chamber music for piano & strings by A. Dvorak
- Ori & Omri Epstein, Complete works for piano & cello by L. Beethoven

2020 :

- Orchestre Philharmonique Royal de Liège, conducted by Jean-Jacques Kantorow, Brussels Philharmonic, conducted by Stéphane Denève, and soloists of the Music Chapel, «Tribute to Ysaÿe»
- Biel Solothurm Symphony Orchestra, conducted by Kaspar Zhender, Louis Lortie, Frank Braley, Victoria Vassilenko, Iris van Wijnen, Double concerti K. 365, K. 505 & K. ANH. 56/315F by W.A. Mozart

2021 :

- Christine Lee, «Voyage»

2022:

- C. Franck, Complete Chamber Music

- Jérémy Garbarg, « Parlando »

- Sergei Redkin

-

Forthcoming :

- Mendelssohn & Enescu's Octets

European network of opera academies: The Music Chapel is part of the enoa network. The enoa network was born from the wish of a number of operatic institutions – opera academies, festivals, foundations and producers – to work more closely together to support the professional integration of the most talented young artists and to support the development of their artistic ambitions. With the backing of the European Commission's Culture Programme since 2011 and Creative Europe Programme since 2016, enoa has been working to train emerging artists and promote their mobility, while encouraging the creation and performance of new operas all over Europe. Thanks to its first years of experience, the enoa network renewed its commitment to artists at the start of their professional careers and entered its third mandate in 2020. Thirteen member institutions, eighteen associated partners, over a thousand young artists and some three hundred professionals make up the enoa community.

4. Artists Village:

A genuine laboratory for life and musical creation in Europe. The Music Chapel welcomes between 70 and 80 young artists from about 20 countries around the world, from Belgium to Latin America, the US, Australia and Japan, China, South Korea, Russia and many European countries. The Music Chapel proposes activities that enable them to have exchanges with other musicians, to attend workshops and conferences.

5. The infrastructure:

All this work takes place in a space and an environment that enable concentration, work, meditation, social interaction and exchanges. The quality of this exceptional setting as well as the proximity between the staff of the Music Chapel, the teaching team and the young musical talents, form an integral part of the pedagogical project.

6. Community Projects :

A new social project was introduced at the Music Chapel in 2012 with the arrival of Maria João Pires and the launch of the Equinox choirs. The creation of a "Community Projects" chair in 2016, with the support of the private foundation Futur21, reinforced the Music Chapel's desire to broaden the field of social applications offered to the young talents enrolled in all the disciplines taught at the Music Chapel. The chair encompasses all the social and sustainable projects that the Music Chapel has included in its season,

both on its site in Waterloo and outside in various musical performance and production projects. Opening oneself to the other, to other types of audiences and sharing one's talent: that is the aim of the "Community" project. These projects take on different shapes:

- Sharing music with audiences who do not have easy access to music (Nativitas and Convivial NPOs, concerts in prisons, rest homes and hospitals).
- Music as a source of reflection, with concerts on social and topical themes.
- The transmission of music teaching to disadvantaged children (Equinox choirs).
- Ecology, sustainability, sharing: music can help change the world!

1939: ‘A haven of peace away from the bustling city’

The **Queen Elisabeth Music Chapel** was founded at the initiative of Queen Elisabeth and the violinist and composer Eugène Ysaÿe.

From the outset, its objective was to receive young musicians by offering them a perfectly adapted working environment in what could be described as a modern ‘Villa Medici’.

Thanks to the support of Baron Paul de Launoit, the project quickly took shape. In the small town of Argenteuil, not far from Brussels, architect Ivan Renchon designed a thoroughly modernist building resembling a transatlantic liner.

It was inaugurated on **11 and 12 July 1939**. The building contained a concert and rehearsal studio, a dining room, offices for the director and the general secretary, and above all eight studios, very well soundproofed for the time, to house eight young Belgian musicians. Each resident had two rooms: a working studio with a piano and a bedroom with a bathroom. When he created the building, Ivan Renchon also designed the interior in collaboration with the Kortrijk-based Ateliers De Coene. The dining room, in particular, still contains the original furniture as well as the light fittings made by the Parisian firm Perzel.

A few months after the Music Chapel was inaugurated, war broke out and the Chapel’s activities were suspended. Briefly occupied by German officers, the building was returned to its first residents in October 1940. The students completed their training in 1943, in the midst of the war. The Chapel then closed its doors until 1951.

In **1953 - 54**, an annex, which was in perfect harmony with the main building, was added to accommodate the 12 finalists of the Queen Elisabeth International Music Competition.

Designed by Ivan Renchon’s son, Jules Renchon, this now-destroyed annex contained six studios, a recreation and conference room, and a gym.

The buildings were renovated between **1987 and 1992**, and two years later, the Music Chapel was listed as a monument and heritage site.



Group photo with Queen Elisabeth - 1959



Southern façade - 1964



Dining Room



The Queen’s Studio



The Queen’s Studio



Extending the infrastructure

2015: The de Launoit Wing at the service of a growing project

A new laboratory

he inauguration in 2015 of a new wing, a success in terms of both the architecture and the surprising functional possibilities it offers, now makes it possible for the Music Chapel to work openly in its laboratory and to develop its permanent musical activity.

The de Launoit Wing rests on:

- an increase in the capacity of the artist residencies, a specificity of the project since 1939;
- an increase in the number of training spaces;
- the creation of a new performance and recording studio.

Since the overhaul of its artistic project in 2004, the Music Chapel has grown from 12 artists in residence to about 70 young artists, and it organizes over 300 concerts annually.

The 1,800 m2 available in the historic building were no longer suited to the institution's expansion. The Music Chapel was no longer able to accommodate enough young artists, although that was its initial specificity!

The development of the Music Chapel was therefore essential if it was to maintain a competitive position with regard to other leading musical training institutions around the world. This new wing therefore enabled the growth of its activities and to relieve the existing building from the increasingly intense use to which it was put.

The de Launoit Wing doubles the available space to 3,500 m2, by adding mainly:

- 20 additional housing studios making it possible for the Music Chapel to welcome a greater number of artists in residence;
- a large music studio offering not only a rehearsal and performance space but also a recording studio fitted by our partner, the music production and publishing group Outhere;
- 2 music studios at the disposal of the professors, musicians and ensembles in residence or in concert;
- an Artists Village (restaurant, kitchen, lounge and leisure area) , offering a high-quality environment that is necessary to achieve the objectives of the Music Chapel.



The Future of the Music Chapel

Extending the residence and the laboratory

Since its opening on 11 July 1939, the Music Chapel has stood out as a centre of musical excellence, one that had the added specificity of housing the artists on campus. From 1939 to 2004, the Chapel welcomed between 8 and 12 young talents in residence annually for three-year periods.

In 2004 the Chapel launched a more open and flexible program of excellence for dozens of young musicians from around the world. Very soon, the need to adapt the housing and work infrastructure made itself felt. Ten years later, on 27 January 2015, Queen Paola inaugurated a new building, the de Launoit Wing.

This new arrangement, which made it possible to welcome more young artists in residence (either for prolonged stays or on a short- term basis), enabled the unprecedented development of the Chapel’s artistic project with between 60 and 80 artists in residence each year.

The Music Chapel has also been able to raise the number of concerts performed, concerts enjoyed by an audience of tens of thousands of music lovers each season and recognized by the public authorities of all levels.

Six years after this landmark evolution pursued by the Chapel, the need for new extensions is once again on the agenda, this time around two distinct and complementary projects:

- On its historic site, the development of housing and rehearsal spaces has become a reality thanks to the success of the overhauled artistic program since 2015, the increase in the number of projects pursued by young artists, and finally the Chapel’s desire to be able to accommodate orchestral ensembles and creative projects on its campus. The pavilion project was realized by the architectural office Synergy and Kahle Acoustics.
- On the site of the Berlaymont plain, the municipality of Waterloo, in consultation with the Music Chapel and with the support of InBW (Intermunicipal association of Walloon Brabant), is launching a major arts infrastructure project that includes a performing arts venue with a seating capacity of between 600 and 1,000.

The development of pavilions initiated by the Chapel is envisaged within two to three years (2023–2024).

The development of a new performing arts venue, initiated by the municipality of Waterloo, should occur in the longer term.

The directors of the Music Chapel are determined to envisage the development of infrastructures that respect the identity of the project and its historic campus, and that also allow the institution to excel in terms of the artistic program on offer in order to reassert its position among the world’s leading centers of musical excellence.

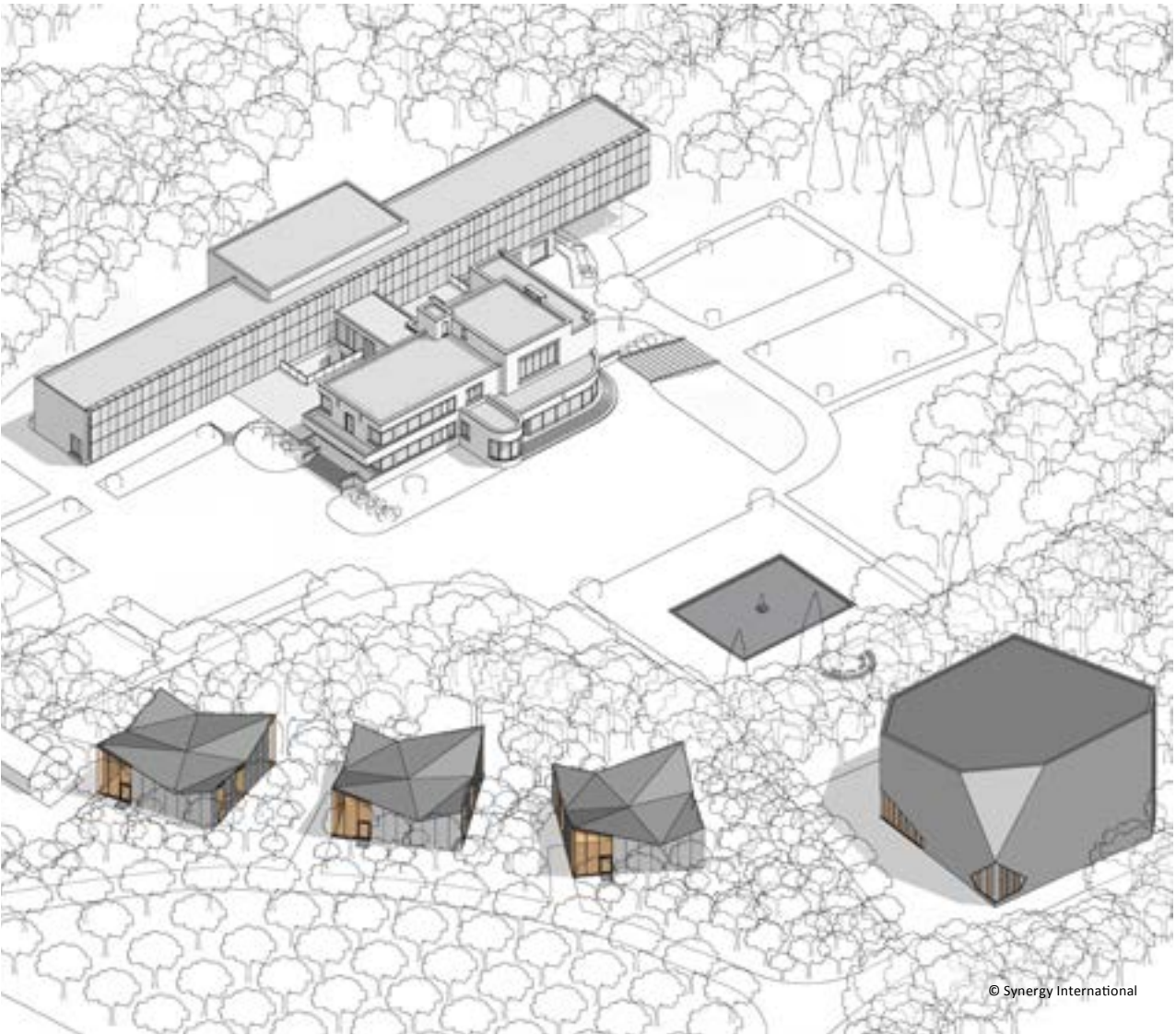

Funding: Sponsorship and Patronage

The Music Chapel derives more than 80 per cent of its budget from the private sector and the rest from public aid. This is a quite unusual way of functioning in the education and culture sector in Belgium and continental Europe.

The institution is indeed supported by various types of Sponsors, Foundations, and many private Patrons. In recent years, besides developing artistic projects, the Music Chapel has been looking for Patrons abroad – notably, in the United States and Canada, where it collaborates with the King Baudouin Foundation. Bequests are another important form of funding and can be dedicated to various specific projects, in agreement with the bequeather.

Through their involvement and generosity, our Sponsors, Foundations and Patrons contribute not only to the preservation of a European cultural heritage, but also to the maintenance of a listed heritage. Above all, they participate in an ambitious, forward-looking project aimed at youth development with the prospect of a high-level music career: they share the passion of the young artists chosen for their talent and enable them to benefit from an outstanding “tailor-made” training program, regardless of their financial situation, so that they can fully embark on an international career.

Private support is therefore key to the success of this project in the service of art, and **YOU can contribute to its success.**

Join us in this passion-driven space and support culture in general, and music and youth in particular!

Contact:

Laurence Godfraind, Funding Director
lgodfraind@musicchapel.org

Elisabeth Bruyns, Private Funding Coordinator
ebruyns@musicchapel.org

Sabine Nallet, Funding Coordinator
snallet@musicchapel.org



QUEEN MUSIC
ELISABETH CHAPEL

Share emotions!
Support rising talents!

Membership & Funding Departement

+32 (0)2 352 01 16 - funding@musicchapel.org

IBAN : BE20 3101 2393 3956 – BIC : BBRUBEBB



Your tailor-made event at the Music Chapel!

Besides being a training centre, the Music Chapel is also the ideal setting for your event, whether private or corporate: easily accessible from Brussels or any other location in Belgium, with a vast private car park, several rooms with distinct features, and an exceptional and unique setting, the Music Chapel meets all the conditions to make your dream come true! The team of the Music Chapel will work with you to devise tailor-made solutions for your event. A family reunion, a meeting with your partners, an event to thank your clients, an intimate moment with your closest colleagues ... Everything is possible in this unforgettable place!

Contact : Bénédicte Bruynseels
+32 (0) 2 352 01 14 – bbruynseels@musicchapel.org
Our exclusive catering partner is Choux de Bruxelles

The Queen’s Studio

- **Listed building:** 170 m²
- 3 rooms leading into each other
- **Capacity:** 100 sièges - 200 debout
- Screen - Projector - 1 HF microphone



Restaurant

- **New building:** 153 m²
- **Capacity:** 100 seated - 160 standing



Council Room

- **Listed building:** meeting room
- Large table with sockets
- **Capacity:** 20 seats
- Large screen with internet connection (cable + wifi)



Haas-Teichen Concert Hall

- **New building:** 144m² + balcony
- **Capacity:** 240 seated - 140 standing
- **2 concert pianos** (Yamaha CFX & Bösendorfer)
- Screen - Projector - 1 HF microphone



General information

Center of excellence for artistic training

Anne-Lise Parotte, Artistic Director

Cello Department

Gary Hoffman, master in residence
Jeroen Reuling, professor
Dana Protopopescu, piano coach
Katsura Mizumoto, piano accompanist

Chamber Music Department

Corina Belcea, master in residence
Miguel da Silva, master in residence
Jean-Claude Vanden Eynden, master in residence

Piano Department

Frank Braley, master in residence
Avedis Kouyoumdjian, master in residence
Jean-Claude Vanden Eynden, concert coach

Viola Department

Miguel da Silva, master in residence
Kojiro Okada, piano accompanist
Salih Can Gevrek, piano accompanist

Violin Department

Augustin Dumay, master in residence
Lorenzo Gatto, guest professor
Yossif Ivanov, guest professor
Christia Hudziy, piano accompanist
Dana Protopopescu, piano coach

Voice Department

José van Dam, master in residence
Sophie Koch, master in residence
Kira Parfeevets, opera coach
Sophie Raynaud, coach
Olivier Reboul, coach
Philip Richardson, coach & piano accompanist
Federico Tibone, Italian coach
Hélène Lucas, coach
Marie Datcharry, piano accompanist
Andreas Zimmerman, piano coach (lied & melody)
Julie Delbart, piano accompanist
Christiane Gleis, German coach
Darren Ross, dance workshop

Associate Artists

Quartetto Adorno
Riana Anthony
Nareh Arghamanyan
Quatuor Arod
Hrachya Avanesyan
Amalia Avilan
Nikita Boriso-Glebsky
Lidy Blijdorp
Busch Trio
Benedetta Bucci
Elina Buksha
Jane Cho
Pau Codina
Elia Cohen-Weissert
Trio Dali
Charles Dekeyser
Hélène Desaint
Bertrand Duby
Dania El Zein
Ori Epstein
Jonathan Fournel
Lorenzo Gatto
Jérémy Garbarg
Julie Gebhart
Quatuor Girard
Nathanaël Gouin
Marie Hallynck
Hermès Quartet
Natania Hoffman
Fabien Hyon

Yossif Ivanov
Pavel Kolesnikov
Leon Kosavic
Louise Kuyvenhoven
Adam Krzeszowiec
Sarah Laulan
Christine J. Lee
Kerson Leong
Julien Libeer
Yung-Hsin
Lou Chang
Anneke Luyten
Plamena Mangova
Dorine Mortelmans
Maria Milstein
Josquin Otal
Sébastien Parotte
Deborah Pae
Liya Petrova
Edvard Pogossian
Milos Popovic
Júlia Pusker
Djordje Radevski
Sergei Redkin
Rolston String Quartet
Vineta Sareika
Amandine Savary
Julie Sévilla- Fraysse
Yu Shao
Astrig Siranossian

Julia Szproch
Thalea Quartet
Georgy Tchaidze
Valentin Thill
Shadi Torbey
Katarina Van Droogenbroeck
Ella Van Poucke
Iris Van Wijnen
Victoria Vassilenko
Rosalind Ventris
Manuel Vioque-Judde
Esther Yoo
Trio Zadig
Nancy Zhou



Queen Elisabeth Music Chapel,
social-purpose corporation

Board of Directors

Bernard de Launoit, Chairman & CEO
Johan Beerlandt
Bernard Boon Falleur
Pierre Boucher
Géry Daeninck
Frédéric d’Ansembourg
Philippe de Buck van Overstraeten
Yvan de Launoit
Fabrice du Chastel de la Howarderie
Paul Dujardin
Sylvia Goldschmidt
Denis Solvay
Jeanine Windey

Equinox, chorale d’enfants, asbl
Board of Directors

Bernard de Launoit, President
Sophie Gosselin
Simone Susskind
Martine Jonet
Arnaud Jansen
Arnaud Grémont

Queen Elisabeth Music Chapel,
public utility foundation

Board of Directors

Michel Delbaere, Chairman
Bernard de Launoit, Executive President & CEO
Géry Daeninck
Yvan de Launoit
Fabrice du Chastel de la Howarderie
Paul Dujardin
Bernard Focroulle
Sylvia Goldschmidt
Pierre Gurdjian
Viviane Reding
Frans van Daele

Members of the Executive Committee

Bernard de Launoit, Executive President & CEO
Sophie Gosselin, General Secretary & COO
Anne-Lise Parotte, Artistic Director
Quentin Bogaerts, Financial Director
Laurence Godfraind, Funding Director

Honorary Chairmen

Jean-Jacques de Launoit
Jean-Pierre de Bandt
Vincent Pardoën

Artistic Committee

Bernard Focroulle, Chairman
Peter de Caluwe
Bernard de Launoit
Gilles Ledure
Christian Renard
Anne-Lise Parotte, Artistic Director

Strategic Committee

Michel Delbaere, Chairman
Bernard Boon Falleur
Pierre Boucher
Gery Daeninck
Bernard de Launoit
Fabrice du Chastel de la Howarderie
Pierre Gurdjian

Ambassadors Committee

Sylvia Goldschmidt, Chairman
Werner Van Lembergen, Vice-Chairman
Axel Miller
Willem Van de Voorde

American Friends

In collaboration with:
King Baudouin Foundation United States

Georges Ugeux, Chairman
Elizabeth Moran

Canadian Friends

In collaboration with:
King Baudouin Foundation Canada

Team, public interest foundation



Executive Committee

Bernard de Launoit, Executive President/CEO
Sophie Gosselin, General Secretary/COO
Anne-Lise Parotte, Artistic Director
Quentin Bogaerts, Financial Director
Laurence Godfraind, Funding Director

Communication Department

Johanna Filée,
Head of Communication Department, Audience Management & Protocol
Laure Raimondi, External Publications, Web Master
Lia Navarrete, Community Manager, In-house Media Producer & Graphic Designer
Jennifer McEke, Audience Management Assistant
Jorge Varela, Volunteer Assistant & Guided Tours
Wash Productions, Video & Live Streaming (www.washproductions.com)
Mégane Fontaine, Photographer
Griffe, Graphic Design

Artistic Department

Anne-Lise Parotte, Artistic Director
Danaé Baltsavias, Artistic Coordination (cello, viola, chamber music & Interdisciplinary Chamber Music), Admission, Students Mediation Support
Aurélié Loreau, Artistic Coordination (piano & violin) & Auditions - Student support
Natsumi Krischer, Artistic Coordinator (Voice), Enoa Contact & Project Manager
Margaux Davin, Administrative Support

Community Projects Department

Géraldine Sax, Coordinator
Mélanie Pelé, Educational Coordinator
Ludovic Maertens, Project Manager

Membership & Funding Department

Laurence Godfraind, Funding Director
Elisabeth Bruyns, Private Funding Coordinator
Sabine Nallet, Funding Coordinator

Finance & Administration

Quentin Bogaerts, Financial Director
Paul Borschette, Administration
Regie Constellation, Bookkeeping (regieconstellation.be)
RSM Belgium, Financial Expertise & Corporate Governance

Logistics Department

Alain Canivet, Logistic
Muriel Duyck, Piano Maintenance
Aurore Somme, Housekeeping Staff
Lami Tchabebou, Housekeeping Staff

Global Engagement

ARTISTS

• Artists in residence/associate/guest	138
• European nationalities	24
• Non-European nationalities	17

ARTISTIC PROGRAM

• Sections	6
• Masters, guest Masters, professors, coaches	42
• Accommodations	5.000 nights & 11.000 meals
• Library	15.000 scores
• Instruments Fund	70 strings & 37 pianos

ON STAGE PROGRAM

• Concerts produced or coproduced MuCH Music Season	300
• MuCH Waterloo Festival	90 concerts
• Music Chapel Festival in Flagey	26 concerts / 4 days
• Gala Concert in Bozar	23 concerts / 4 days
• Contemporary creations & commissions	1 concert
• International voice coproductions	3
• MuCH Off	3
• MuCH on Tour EU/Japan/US/India/Korea/Canada/UAE	140 activities and guided tours
• Collaboration with festivals & concert halls	Worldwide
• Concerts with orchestras	50
	40

COMMUNITY PROJECTS

• Concerts in hospitals/prisons/care institutions/children’s choirs	30
• sensory impaired people	
• MuCH for Schools & Academies	90

CULTURAL DIPLOMACY

• State visits, Foreign Affairs missions & United Nations	4
---	---

PROMOTION

• MuCH on Air & Radio recordings	150 livestreams / broadcasts
• Number of publications	4 new albums (19 since 2007)

AUDIENCE

At the Queen Elisabeth Music Chapel	105.000
• Subscriptions MuCH Music Season (Capacity: 250 seats)	35.000
• On Tour	350
	70.000



Cello Prelude 2022 © Mégane Fontaine



Zachary Mowitz, American cellist
Community projects

ANNUAL BUDGET

• Private funding: 80% to 85% of the annual budget	€ 3.5m
• Belgian, American & Canadian Friends	

Administrative team

27

DIGITAL MEDIA

• Youtube		
Total video views	830 000	
Subscribers	3 700	
• Facebook		
Followers	13 000	
• Instagram		
Followers	4 200	



Contact

Bernard de Launoit,
Executive President & CEO
bdelaunoit@musicchapel.org

Finance Department

Quentin Bogaerts, Financial Director
qbogaerts@musicchapel.org

Concert Department

+32 (0)2 352 01 14

Bénédicte Bruynseels,
Head of Concert Department
bbruynseels@musicchapel.org

Sophie Gosselin,
General Secretary & COO
sgosselin@musicchapel.org

Community Projects Department

+32 (0)2 352 01 15

Géraldine Sax,
Project Manager
gsax@musicchapel.org

Communication Department

+32 (0)2 352 01 17

Johanna Filée,
Head of Communication
jfilee@musicchapel.org

Membership & Funding Department

+32 (0)2 352 01 13

Laurence Godfraind,
Funding Director
lgodfraind@musicchapel.org

Artistic Department

+32 (0)2 352 01 12

Anne-Lise Parotte,
Artistic Director
alparotte@musicchapel.org



Queen Elisabeth Music Chapel, *public interest foundation*

We would like to thank

En collaboration avec / In samenwerking met / In collaboration with

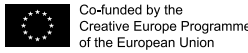
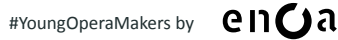

This project has been funded with support from the European Commission. This publication [communication] reflects the views only of the author, and the Commission cannot be held responsible for any use which may be made of the information contained therein.



Queen Elisabeth Music Chapel, *public interest foundation*

We would like to thank

Soutien public / Overheidssteun / Public support



Partenaires institutionnels / Institutionele Partners / Institutional partners



En collaboration avec / In samenwerking met / In collaboration with



Queen Elisabeth Music Chapel, *public interest foundation*

We would like to thank

Partenaires Structurels / Structurele Partners / Structural Partners

Principal Sponsor



Co-sponsors



Fondations / Stichtingen / Foundations



GUTTMAN
COLLECTION

Entreprises Partenaires / Corporate Partners Club

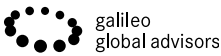

All the MuCH Community
Les Mécènes / De Mecenassen / The Maecenas



Les généreux testateurs pour leurs legs / De gulle erflaters voor hun erfenis /
The generous testators for their legacy



Conception and development

Queen Elisabeth Music Chapel

Translation

Patrick Lennon (English)

Katy Corluy (Dutch)

Photography

Mégane Fontaine (Mégane F. Photography)

Michel Cooreman

Eric Bouvier

Going to press

05.09.2022

Queen Elisabeth Music Chapel, *public interest foundation*

Under the Honorary Chairmanship of Her Majesty Queen Paola

Correspondence: Chaussée de Tervuren 445- 1410 Waterloo- Belgium

Corporate address: Rue Brederode 14, B-1000 Bruxelles- BCE 459 245 906

Tel: +32 (0)2 352 01 17- Fax: +32 (0)2 351 10 24- www.musicchapel.org

Publisher: B. de Launoit - Queen Elisabeth Music Chapel - September 2022

Chaussée de Tervuren, 445- 1410 Waterloo- Belgium

It's more than a school, it's an experience!

www.musicchapel.org